

## STEC WL AD SERIES ADAPTER

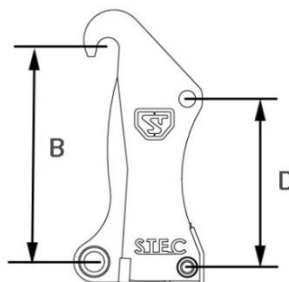

The STEC WL AD series hydraulic ISO adapter is designed as an ISO 23727 quick coupler adapter.

With this adapter, you can attach Volvo L90-120 attachments, equipped with ISO 23727 quick couplers, to Volvo L150-L220 quick couplers, for example.

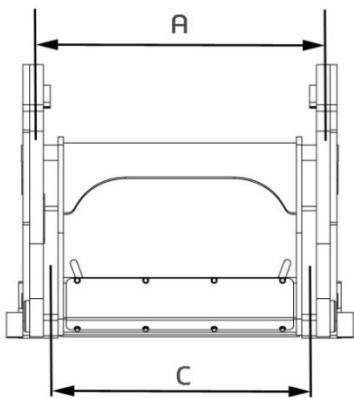

MACHINE WEIGHT	PRODUCT CODE	WIDTH (A)	C-C (B)	WIDTH (C)	C-C (D)	WEIGHT
22-35 t	STEC WL AD 180-120	1050	780	1000	615	360